

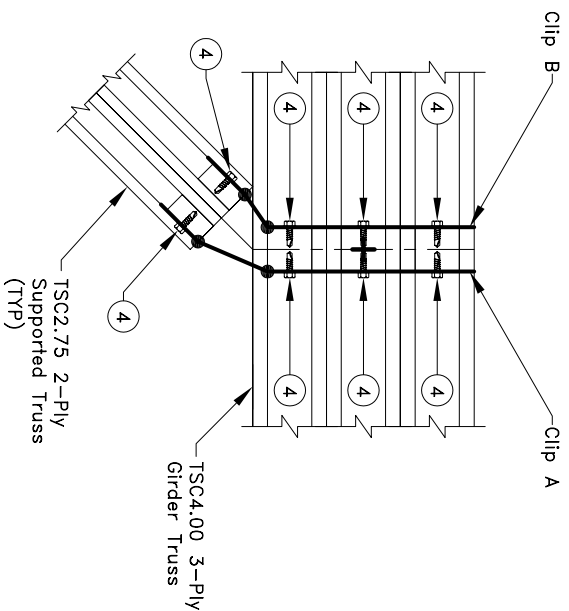

$$R_v = U = 150 \text{ lbs}$$



Clip Pair Cut Section

Girder web placement: Center lines of supported trusses line up with center of girder web, as shown above. The girder web center is marked with a  as shown.

General Notes:

1. All edge distances, end distances and spacing are 9/16" minimum.
2. Circled numbers represent the quantity of #10 self-drilling tapping screws.
3. Girder must be analyzed with concentrated loads from supported trusses in line with center of correctly placed girder webs. "Clip Pair Cut Section" gives correct girder web placement information.
4.  = Clip Bend; Bend clip only once.
5. "Rv" refers to total vertical reaction of supported truss, and "U" refers to uplift of supported truss.
6. Cold formed steel calculations are per the 2004 addendum to the 2001 AISI North American Specification for the design of cold-formed steel structural members.

General Clip Information

18ga ASTM A653 SS Grade 33 Class 1 G60
Bare metal thickness = 0.0428"

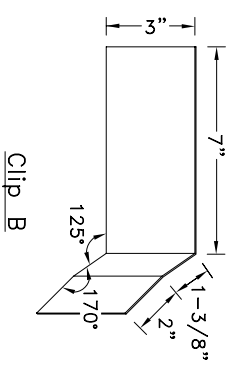
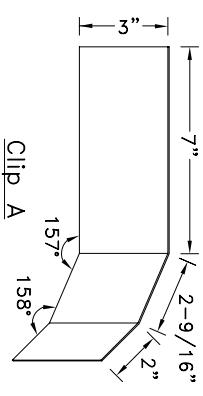

www.TrusSteel.com

Florida: 1950 Marley Drive / Haines City, FL 33844 / (800) 755-6001
Missouri: 13389 Lakefront Drive / Earth City, MO 63045 / (800) 326-4102
California: 8351 Rovana Circle / Sacramento, CA 95828 / (800) 877-3678

Custom 45° Connection For 2-Ply Supported Truss To 3-Ply Girder

ITW Building Components Group, Inc. shall not be responsible for any performance failure in a connection due to a deviation from this detail. Any variation from this detail shall be approved in advance by ITW Building Components Group, Inc.

Custom Detail:

TS-CD-TT-4501-008

Date:

09/04/08

Custom Detail Category:

Truss-to-Truss Connection